

(Licensed by the American Kennel Club)



PREMIUM LIST

AKC TRACKING DOG EXCELLENT TEST

Event #2019277001

Closes February 28, 2019 at 8pm at
O'Charley's Restaurant, 1242 S. Kirkwood, St Louis, MO

JUDGES

Ulysses James, 19384,4517 Sage Rd, Rochester, Illinois 62563
Connie Austin, 19385, 4517 Sage Rd, Rochester, Illinois 62563



AMERICAN KENNEL CLUB CERTIFICATION

Permission has been granted by the American Kennel Club for
The holding of this event under the American Kennel Club rules and regulations.
James Crowley, Secretary

GENERAL INFORMATION AND TEST RULES

GATEWAY TRACKING CLUB 2019 OFFICERS

President Pat Thayer
Vice President Linda Beisswenger
Secretary Sandi Thompson
Treasurer Sharon Rosenkoetter
Board Members..... Karen Rosso, Carl Rosenkoetter

Tracking Test Chairperson: Pat Thayer, 544 Green Meadows, Beaufort, MO 63013, conobtra@gmail.com, 314-808-1621

Tracking Test Secretary: Shawn Nies, 7572 English Coach Lane, Hazelwood, MO 63042, shawndachs@sbcglobal.net, 314-882-7929

Chief Tracklayer: Carl Rosenkoetter

Test Committee: Officers and members of Gateway Tracking Club

TEST HEADQUARTERS

Sullivan Fairgrounds, Progress Road, Sullivan MO

ROSETTES, PRIZES, AWARDS

A glass container etched with title earned will be presented to each successful participant in the test. An additional award will be presented to those who earn the Champion Tracker title in passing this test.

AREA MOTELS

Gateway Tracking Club recommends each exhibitor check with hotels for their pet policy in advance of your stay.

Baymont Inn-Sullivan
275 N. Service Road W, Sullivan MO
573-367-2211

Motel 6
209 N. Service Road W, Sullivan, MO
573-468-4119

Super 8
601 N. Service Road W, Sullivan, MO
573-468-8076

ENTRY LIMITS: TDX-There are 6 tracks offered with 2 tracks set aside for test workers as set by AKC tracking regulations, Chapter 1, section 17d.

DRAWING FOR ACCEPTANCE INTO THE TEST: The drawing will be held at O'Charley's Restaurant, 1242 S. Kirkwood, St Louis, MO on Thursday, February 28, 2019 at 8pm to determine which entrants will participate in the test and the position of excess entrants on the Alternate List. There will be two drawings – the first draw will be for past test workers. Preference will be given to entrants who have not earned the title of TDX. All entrants will be advised by email, if such address has been provided, on March 1, 2019 or by USPS if no email has been provided.

DRAWING FOR RUNNING ORDER OF TRACKS: The draw will be held at 9:30am at the test headquarters at the Sullivan Fairgrounds.

REFUNDS: Entry fees will be refunded to Alternates who decline to be placed on the Alternate List and to Alternates who do not participate in the test. Entry fees will NOT be refunded to a scheduled entrant who is absent on the test date unless an Alternate is present and runs in the place of the absent dog.

RETURNED CHECKS: There will be a \$25.00 charge for any checks returned.

RISK: The owner or agent entering a dog in a tracking test does so at his/her own risk and agrees to abide by all of the Rules and Regulations of the American Kennel Club. The Gateway Tracking Club assumes no responsibility for any personal injury; death of any person; theft, loss or damage of personal property; theft, injury or death of any animal while at this test site or while in transit to/from the site.

IMPORTANT NOTICE REGARDING USE OF TEST SITE: Permission to use properties in/around Sullivan MO is for this tracking test only. Exhibitors wanting to practice at the site must secure their own permission from the Parks and Recreation Department or the owner of the private property. Practicing at the site within 3 days of the test is prohibited. All dogs must be on lead at all times. We ask you to use the dedicated exercise area when possible and always clean up your dog's waste.

Ambulance, Fire, Police: 911
YOU ARE LOCATED AT
Sullivan Missouri Fairgrounds

Hospitals:

Missouri Baptist Hospital Sullivan
751 Sappington Bridge Road
Sullivan, MO
573-468-4186

Non-Emergency Vet Clinic:

Sullivan Vet Hospital
777 N. Service Road E, Sullivan, MO
573-468-6774
Hours – Mon-Thu 8am-7pm, Fri 8am to 5pm,
Sat 8am-noon

Emergency Vet Clinic:

Sullivan Vet Hospital Emergency After Hours
636-239-0876

MEALS: Grab and Go items will be available the morning of the test. Sunday lunch will be “dutch treat” at a nearby restaurant.

EXTREME WEATHER: The club may cancel the event in extreme weather conditions.

DIRECTIONS TO TEST HEADQUARTERS

FROM THE EAST: Take I-44 West to MO-D (exit 225) toward Sullivan MO and follow MO-D. Then ***

FROM THE WEST: Take I-44 East to MO-D (exit 225) toward St Louis MO and follow MO-D. Then ***

FROM THE NORTH: Take I-55 South crossing into Missouri. Merge onto I-55S via exit 40C toward I-44 West. Merge onto I-44 West via Exit 207 toward Tulsa. Take MO-D (Exit 225) toward Sullivan, MO. Follow MO-D, then ***

FROM THE SOUTH: Take I-55 North crossing into Missouri. Merge onto I-270 North via Exit 196 toward Kansas City. Merge onto I-44 West via Exit 5B toward Tulsa. Take MO-D (Exit 225) toward Sullivan, MO. Follow MO-D then ***

***: Turn onto Progress Drive into the Fairground. This road will lead to the Headquarters building  at the back of the fairground. Please observe parking signs.

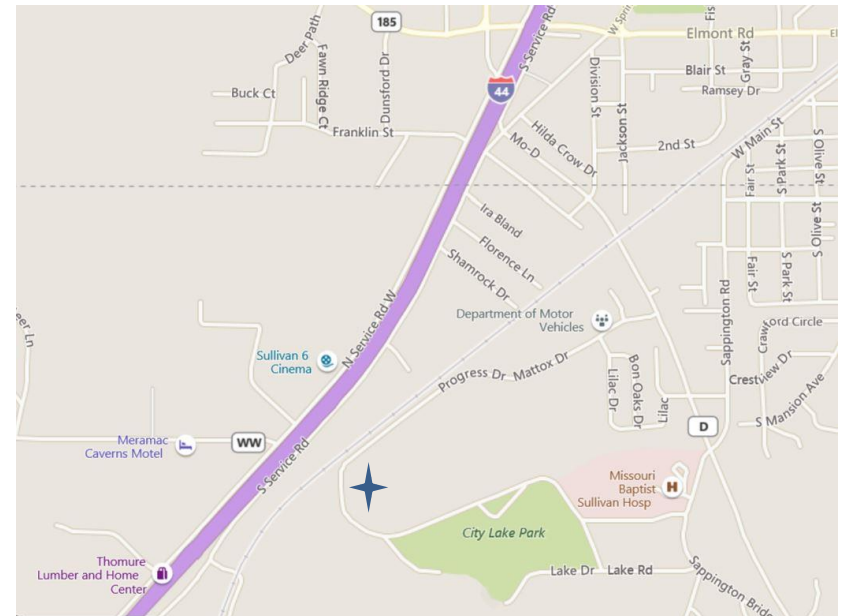

OFFICIAL AMERICAN KENNEL CLUB ENTRY FORM



MAIL TO: Shawn Nies,
 7572 English Coach Lane, Hazelwood, MO 63042
shawndachs@sbcglobal.net
 314-882-7929

Club: Gateway Tracking Club		Date: March 10, 2019	Event # 2019277001
Location: Sullivan Fairgrounds, Sullivan, Missouri		Event type Tracking	Enter in Stake/Test TDX
AKC # <input type="checkbox"/> AKC Litter # <input type="checkbox"/> Foreign Reg. # <input type="checkbox"/> (List Country)		I enclose entry fees in the amount of: \$125.00	
Full Name of Dog:			
Breed:	Call Name:	<input type="checkbox"/> Male <input type="checkbox"/> Female	Date of Birth:
Sire:			
Dam:			
Name of Breeder:			
Actual Owner(s):			
Owner's Address:			
City:	State:	Zip:	
Name of Owner's Agent/Handler:			
Agent/Handler's Address:			
City:	State:	Zip:	
<p>AKC Rules, Regulations, Policies and Guidelines are available on the American Kennel Club website: www.akc.org</p> <p style="text-align: center;">AGREEMENT</p> <p>I certify that I am the actual owner of the dog, or that I am the duly authorized agent of the actual owner whose name I have entered above. In consideration of the acceptance of this entry, I (we) agree to abide by the rules and regulations of the American Kennel Club in effect at the time of this event and any additional rules and regulations appearing in the premium list of this event and entry form and any decision made in accord with them. I (we) agree that the club holding this event has the right to refuse this entry for cause which the club shall deem sufficient. In consideration of the acceptance of this entry and of the holding of this event and of the opportunity to have the dog judge and to win prizes, ribbons, or trophies, I (we) agree to hold the AKC, the event-giving club, their members, directors, governors, officers, agents, superintendents or event secretary and the owner and/or lessor of the premises and any provider of services that are necessary to hold this event and any employees or volunteers of the aforementioned parties, and any AKC approved judge, judging at this event, harmless from any claim for loss or injury which may be alleged to have been caused directly or indirectly to any person or thing by the act of this dog while in or about the event premises or grounds or near any entrance thereto, and I (we) personally assume all responsibility and liability for any such claim; and I (we) further agree to hold the aforementioned parties harmless from any claim for loss, injury or damage to this dog. Additionally, I (we) hereby assume the sole responsibility for and agree to indemnify, defend and save the aforementioned parties harmless from any and all loss and expense (including legal fees) by reason of the liability imposed by law upon any of the aforementioned parties for damage because of bodily injuries, including death at any time resulting therefrom, sustained by any person or persons, including myself (ourselves), or on account of damage to property, arising out of or in consequence of my (our) participation in this event, however such, injuries, death or property damage may be caused, and whether or not the same may have been caused or may be alleged to have been caused by the negligence of the aforementioned parties or any of their employees, agents, or any other persons. I (WE) AGREE THAT ANY CAUSE OF ACTION, CONTROVERSY OR CLAIM ARISING OUT OF OR RELATED TO THE ENTRY, EXHIBITION OR ATTENDANCE AT THE EVENT BETWEEN THE AKC AND THE EVENT-GIVING CLUB (UNLESS OTHERWISE STATED IN THIS PREMIUM LIST) AND MYSELF (OURSELVES) OR AS TO THE CONSTRUCTION, INTERPRETATION AND EFFECT OF THIS AGREEMENT SHALL BE SETTLED BY ARBITRATION PURSUANT TO THE APPLICABLE RULES OF THE AMERICAN ARBITRATION ASSOCIATION. HOWEVER, PRIOR TO ARBITRATION ALL APPLICABLE AKC BYLAWS, RULES, REGULATIONS AND PROCEDURES MUST FIRST BE FOLLOWED AS SET FORTH IN THE AKC CHARTER AND BYLAWS, RULES, REGULATIONS, PUBLISHED POLICIES AND GUIDELINES.</p>			
Signature of owner or his agent duly authorized to make this entry:			
Tel:	Email:		

AKC Rules, Regulations, Policies and Guidelines are available on the American Kennel Club Web site, www.akc.org

AGREEMENT

I (we) agree that the club holding this event has the right to refuse this entry for cause which the club shall deem sufficient. In consideration of the acceptance of this entry and of the holding of this event and of the opportunity to have the dog judged and to win prizes, ribbons, or trophies, I (we) agree to hold the AKC, the event-giving club, their members, directors, governors, officers, agents, superintendents or event secretary and the owner and/or lessor of the premises and any provider of services that are necessary to hold this event and any employees or volunteers of the aforementioned parties, and any AKC approved judge, judging at this event, harmless from any claim for loss or injury which may be alleged to have been caused directly or indirectly to any person or thing by the act of this dog while in or about the event premises or grounds or near any entrance thereto, and I (we) personally assume all responsibility and liability for any such claim; and I (we) further agree to hold the aforementioned parties harmless from any claim for loss, injury or damage to this dog.

Additionally, I (we) hereby assume the sole responsibility for and agree to indemnify, defend and save the aforementioned parties harmless from any and all loss and expense (including legal fees) by reason of the liability imposed by law upon any of the aforementioned parties for damage because of bodily injuries, including death at any time resulting therefrom, sustained by any person or persons, including myself (ourselves), or on account of damage to property, arising out of or in consequence of my (our) participation in this event, however such, injuries, death or property damage may be caused, and whether or not the same may have been caused or may be alleged to have been caused by the negligence of the aforementioned parties or any of their employees, agents, or any other persons. I (WE) AGREE THAT ANY CAUSE OF ACTION, CONTROVERSY OR CLAIM ARISING OUT OF OR RELATED TO THE ENTRY, EXHIBITION OR ATTENDANCE AT THE EVENT BETWEEN THE AKC AND THE EVENT-GIVING CLUB (UNLESS OTHERWISE STATED IN ITS PREMIUM LIST) AND MYSELF (OURSELVES) OR AS TO THE CONSTRUCTION, INTERPRETATION AND EFFECT OF THIS AGREEMENT SHALL BE SETTLED BY ARBITRATION PURSUANT TO THE APPLICABLE RULES OF THE AMERICAN ARBITRATION ASSOCIATION. HOWEVER, PRIOR TO ARBITRATION ALL APPLICABLE AKC BYLAWS, RULES, REGULATIONS AND PROCEDURES MUST FIRST BE FOLLOWED AS SET FORTH IN THE AKC CHARTER AND BYLAWS, RULES, REGULATIONS, PUBLISHED POLICIES AND GUIDELINES.

INSTRUCTIONS

- (Variety) If you are entering a dog of breed in which there are varieties for show purposes, please designate the particular variety you are entering, i.e., Cocker Spaniel (solid color black, ASCOB, parti-color), Beagles (not exceeding 13 in., over 13 in. but not exceeding 15 in.), Dachshunds (longhaired, smooth, wirehaired), Collies (rough, smooth), Bull Terriers (colored, white), Manchester Terriers (standard, toy), Chihuahuas (smooth coat, long coat), English Toy Spaniels (King Charles and Ruby, Blenheim and Prince Charles), Poodles (toy, miniature, standard).
- The following categories of dogs may be entered and shown in Best of Breed competition: Dogs that are Champions of Record and dogs which, according to their owners' records, have completed the requirements for a championship, but whose championships are unconfirmed. The showing of unconfirmed Champions in Best of Breed competition is limited to a period of 90 days from the date of the show where the dog completed the requirements for a championship.
- (Event Class) Consult the classification in this premium list. If the event class in which you are entering your dog is divided, then, in addition to designating the class, specify the particular division of the class in which you are entering your dog, i.e., age division, color division, weight division.
- A dog must be entered in the name of the person who actually owned it at the time entries for an event closed. If a registered dog has been acquired by a new owner it must be entered in the name of its new owner in any event for which entries closed after the date of acquisition, regardless of whether the new owner has received the registration certificate indicating that the dog is recorded in his name. State on entry form whether transfer application has been mailed to the AKC. (For complete rules, refer to Chapter 11, Section 3.)

If this entry is for Junior Showmanship, please give the following information:

JUNIOR SHOWMANSHIP _____ JR'S DATE OF BIRTH _____

AKC JUNIOR HANDLER NUMBER

The above number MUST be included. Should you not have your Junior Handler number, this may be obtained from the American Kennel Club. Phone: (919) 816-3776.

By signing the entry form I (we) certify that the Junior Showman does not now, and will not at any time, act as an agent/handler for pay while continuing to compete in Junior Showmanship.

ADDRESS _____

CITY _____ STATE _____ ZIP _____

■ If Junior Handler is not the owner of the dog identified on the face of this form, what is the relationship of the Junior Handler to the Owner?